

SFA

211

09.11
IND1



The user should retain these instructions for future reference
A lire attentivement et à conserver à titre d'information

IMPORTANT

DO NOT RETURN ANY MERCHANDISE TO THE VENDOR
NE PAS RETOURNER DE MARCHANDISE AU VENDEUR

For customer Service, Returns or Technical Questions, please call Saniflo's Technical support toll-free at
800-571-8191 (USA) or 800-363-5874 (CDN).

Pour le service client, les retours ou toute question technique, merci d'appeler le service technique de Saniflo
au numéro suivant : 800-571-8191 (USA) or 800-363-5874 (CDN).

This product must be installed in strict accordance with local plumbing codes.
Product should be installed by a license plumber.

Le produit doit être installé dans le respect des règlements sanitaires locaux.
Le produit doit être installé par un plombier qualifié.



INSTALLATION AND MAINTENANCE INSTRUCTIONS **INSTRUCTIONS D'INSTALLATION ET D'ENTRETIEN**

SANICOMPACT®

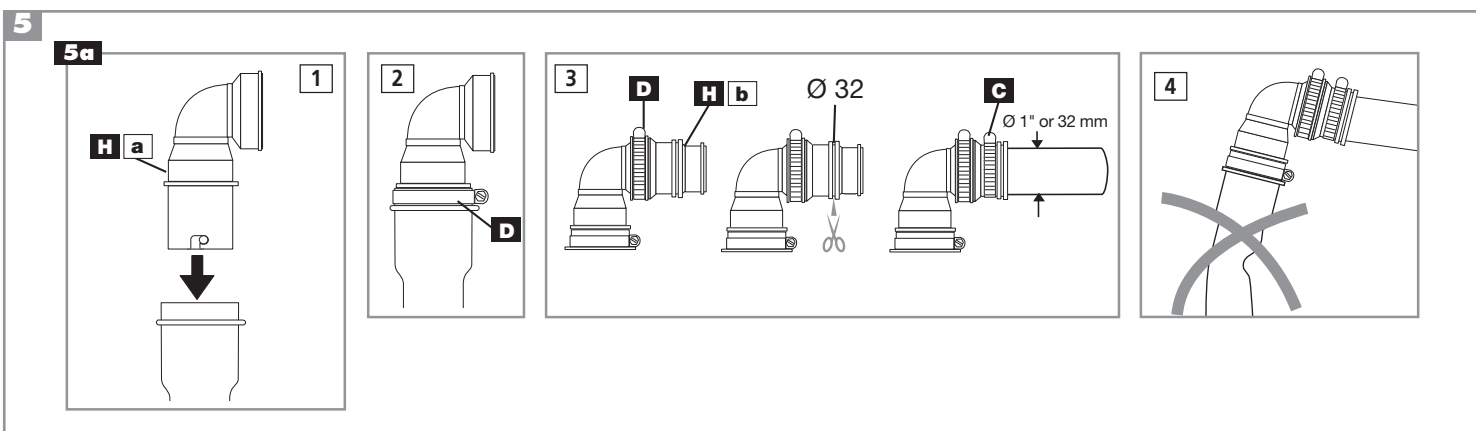
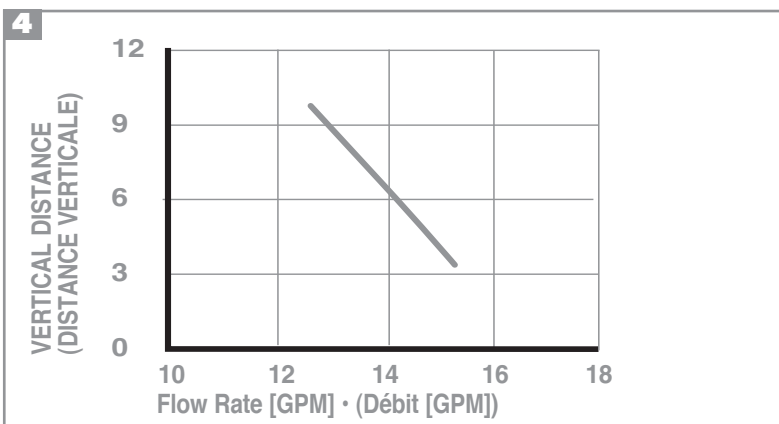
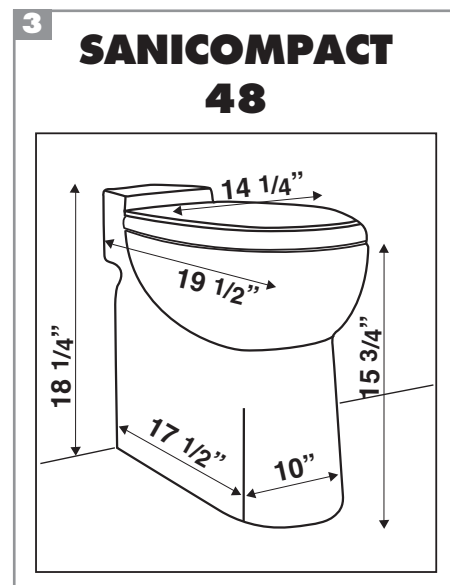
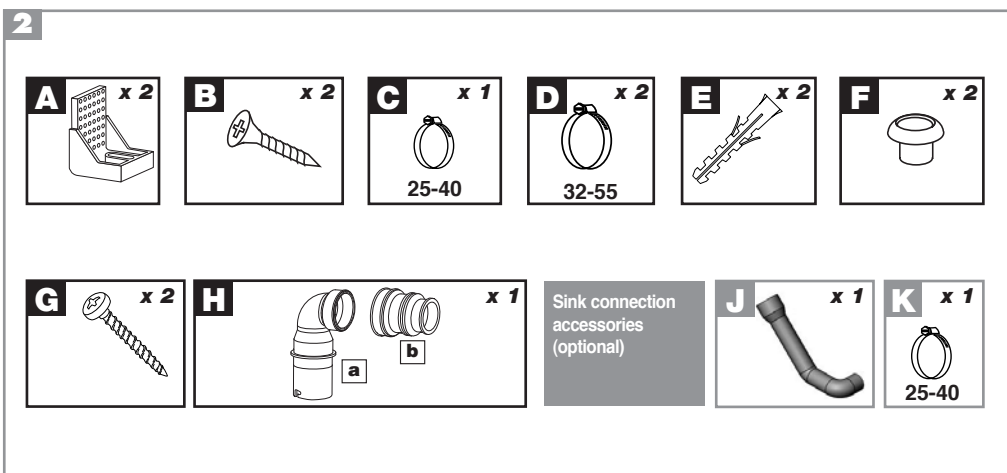
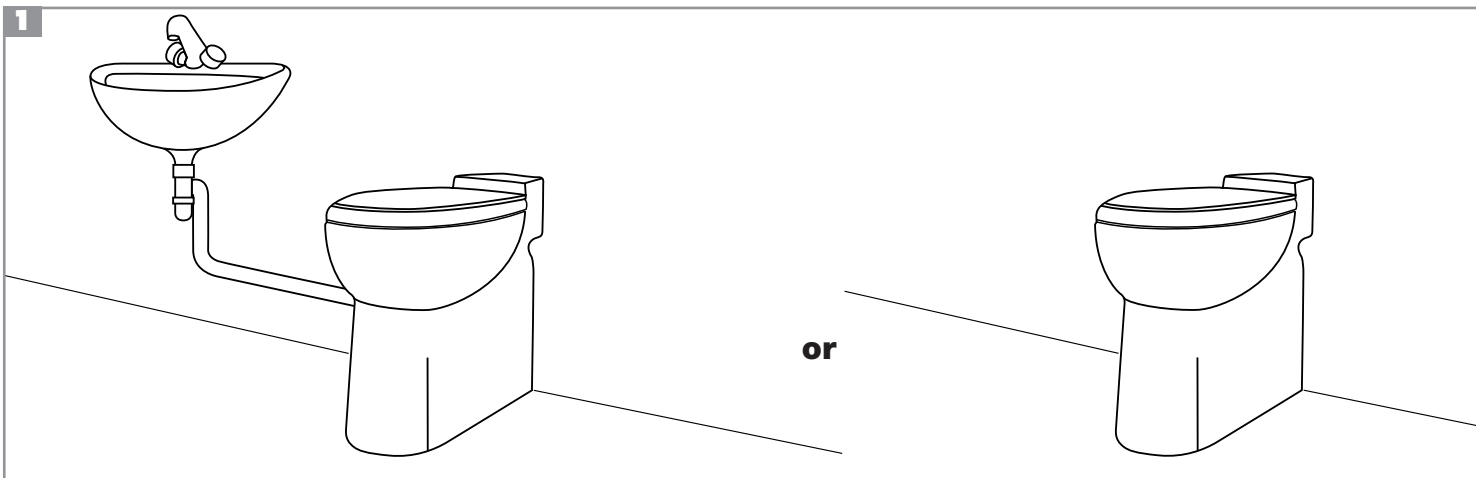

5b

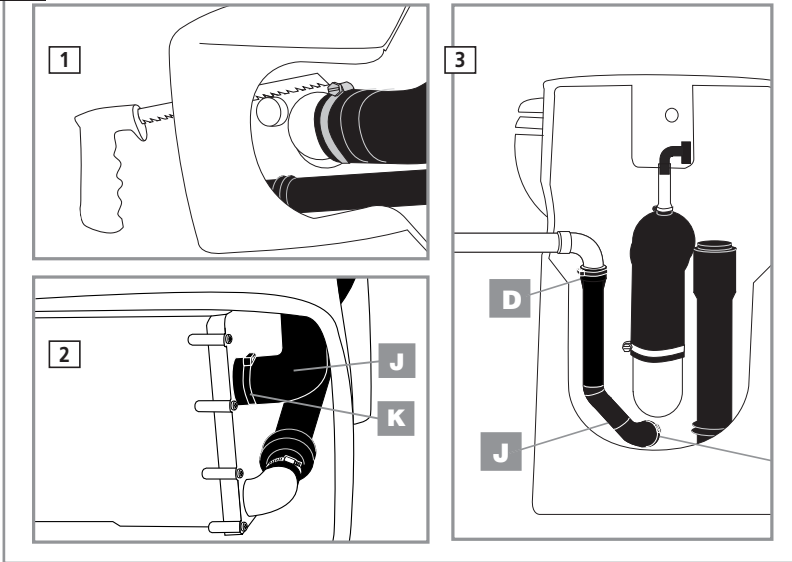

5c

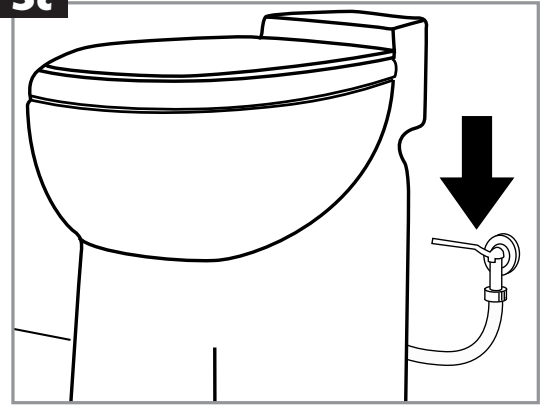

5d

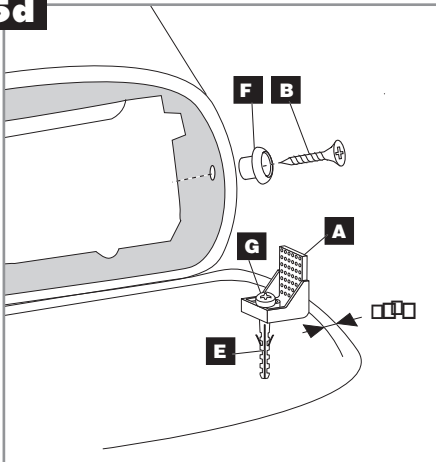

5e

TYPICAL INSTALLATION (INSTALLATION TYPIQUE)

SANICOMPACT® in combination with a gravity fed sink
(Le SANICOMPACT® relié à un lavabo à écoulement par gravité)

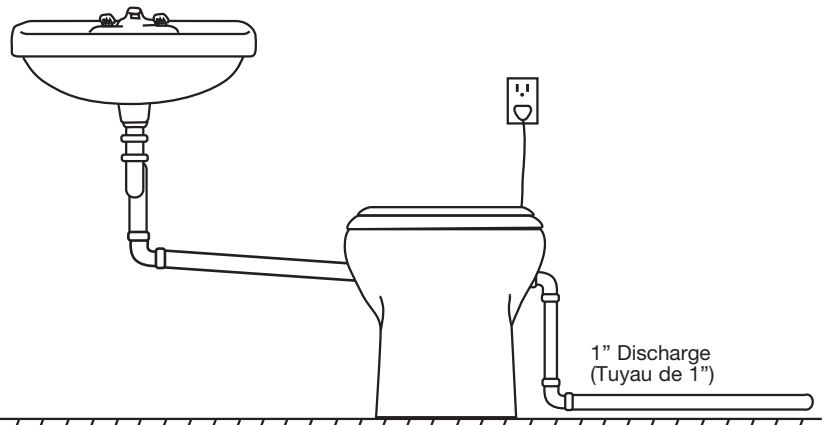

ALTERNATE INSTALLATION (INSTALLATION ALTERNATIVE)

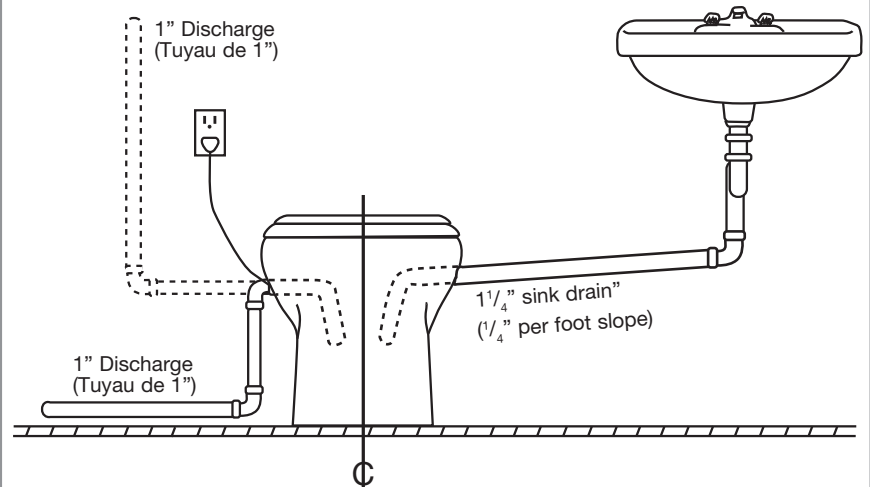

**SANICOMPACT® 48
SFA SANIFLO**

120 V - 60 Hz - 7,2 A - 0.3 HP - ⚡

Sanicompact 48 - 67 lbs



1 GENERAL DESCRIPTION

The **SANICOMPACT**® is a combination of a floor-mounted vitreous china toilet with a built-in macerating and pump system. The **SANICOMPACT**® is meant to be installed in residential applications and can be adapted to discharge gray water from a sink.

The **SANICOMPACT**® is comprised of two major components: the china toilet body and the macerating/pump unit in the base of the toilet.

1a NORMAL OPERATING CYCLE

SANICOMPACT® is controlled by an electronic program with two functions.

- It has a macerating and pumping function. To begin press on either side of the push button (light grey: small flush, dark grey: large flush) integrated to the bowl.
- The pump cycle cleans the washbasin waste. This is an automatic operation that will activate as long as water from the washbasin enters the unit.

2 LIST OF PARTS SUPPLIED

See fig. n°2 (technical data sheet).

3 DIMENSIONS See fig. n°3 (technical data sheet).

4 PERFORMANCE CURVE AND TECHNICAL DATA

See fig. n°4 (technical data sheet).

APPLICATION	1 WC + sink
Maximum vertical pumping	9 feet
Voltage	110-115 V
Frequency	60 Hz
Normal power rating	960 W
Maximum current consumption	7,2 A
Maximum water temperature	95° F
Electric class	I
Degree of protection	IP44
Net weight	67 lbs
Horse power	0.3 HP

WARNING: Only installations conforming to the above specifications are acceptable.

5 INSTALLATION

5a ATTACHING THE TOILET TO THE FLOOR

IMPORTANT: Make sure to install the toilet seat before mounting the bowl.



Place the **SANICOMPACT**® in the desired location.



Trace around the outline of the bowl and mark the position of the fixing screws. Remove the bowl and then mark the position of the fixing brackets 1/2" (15 mm) inside the traced outline.

Drill through the flooring and if necessary, add silicone around the location of the toilet bowl. Install the fixing screws and brackets.

Put the **SANICOMPACT**® in place. Use the screws to fix the **SANICOMPACT**® to the floor.

5a CONNECTION OF THE DISCHARGE ELBOW

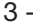
- 1 - Fully insert the elbow  in the end of the rubber waste tube, after turning it to face in the desired direction.
- 2 - Fix the base of the elbow  and tighten it on the rubber waste tube with a clamp .

3 - Connect the sleeve  to the end of the elbow with the clamp . If needed, cut off the end of the sleeve to adapt it to the diameter of the discharge line. Connect the 1" wastepipe into the sleeve and secure with clamp .

4 - **Warning:** Ensure that you do not twist the discharge pipework inside the unit.

IMPORTANT: Protect pipes against freezing with appropriate insulation. If the toilet is installed in an unheated location during freezing periods protect it as follows:

- Shut off the water supply,
- Activate one cycle without water,
- Pour antifreeze in the bowl (2 liters),
- Flush the toilet.

IMPORTANT: Any bends in the discharge pipe run should be smooth radius bends. If using plastic pipe two 45 degree offsets can be used to form a smooth bend.

When connecting the discharge pipe, it is recommended to install a ball valve for servicing purposes on the lowest point of the vertical discharge.

The connection to the soil-stack should be made with an approved TY fitting and should be in accordance with your local plumbing code.

Note: The connection should always be done going into the top of the soil stack to prevent any back pressure into the discharge line from the unit.

5b INSTALLATION OF A SINK

See fig. n°5b 1, 2, 3 (technical data sheet).

To drain a sink into the **SANICOMPACT**®, the sink hose (provided) would have to be installed. Lay the **SANICOMPACT**® on its side and cut the nipple which is situated on the motor cover that can be seen through the back of the unit. Connect the flexible sink hose and secure it to the motor cover using a clamp. A 1-1/4" drain pipe coming from the sink will connect to the other end of the sink hose which should also be secured by means of a clamp. Note that if the sink is installed on the left hand side of the bowl (while facing the front of the toilet), it will be required to have additional back room to create a loop into the sink hose connection. As the discharge line interferes with the sink hose connection, this will only be required when the sink is installed to the left of the bowl.

5c WATER SUPPLY CONNECTION

See fig. n° 5c (technical data sheet).

For the best possible flushing action, the **SANICOMPACT**® needs to be connected to a 1/2-inch water supply. The **SANICOMPACT**® is supplied with a supply hose. The copper end of this supply tube will fit inside the 3/8-inch compression end of a shut-off valve. Due to the international distribution of our product range, it may be possible that the tip of the supply connector is metric. Simply cut this portion off and you are left with a 3/8" connector.

Note that a 3/8" compression fitting (not provided) is required for the installation of the water supply line.

5a ELECTRICAL CONNECTION

The **SANICOMPACT**® should be connected to a 120 V, 60 Hz, 15 Amp. Ground Fault Circuit Interrupter, (either of the breaker or receptacle type).

Connect only to receptacle protected by a ground fault circuit.

Warning: risk of electric shock - this pump is supplied with a grounding conductor and grounding type attachment plug to reduce the risk of electrical shock be certain that it is connected only to a properly grounded - type receptacle.

Note: Do not connect the **SANICOMPACT**® to a power source supplied by an inverter.

START-UP AND PROGRAMMING

59 START-UP

- 1 - Plug in the power socket. Wait 20 seconds: appliance initializing. Open the water tap to rinse well. Start the **normal flush by pressing the dark grey button**. Put a few sheets of toilet paper down in the bowl and flush again.

Note: This unit does not need to be vented.

- 2 - Turn on the sink tap. The unit should sink activate automatically.
- 3 - Demount the bowl and check the water tightness of all connections.
- 4 - **WARNING:** Leaking faucets will cause the unit to activate automatically.

57 PROGRAMMING

The length of your **SANICOMPACT®**'s flush varies according to which cycle you choose.

Eco flush (by default, light grey button):

19 seconds and 1 gallon (3.8L): rinsing of the bowl for 10 seconds, the pump works for 7 seconds (for 7 seconds, the bowl continues to fill), then the bowl fills again for 2 seconds.

You can lengthen the first rinse of the eco flush to 16 seconds if the default flush is not enough.

Normal flush (dark grey button):

25 seconds and 1.32 gallons (5L): The bowl is rinsed for 16 seconds, the pump works for 7 seconds (for 7 seconds, the bowl continues to fill) then the bowl fills again for 2 seconds.

To re-program:

Note: Only the ECO option can be reprogrammed.

- Hold the ECO button (light grey button) down for 5 seconds.
- The motor works for 2 seconds, this means you have entered programming mode.
- Each time you press the dark grey button you increase the length of the ECO flush by 1 second: each time you press it will be validated by the motor running for a short period.
- Each time you press the grey button you decrease the length of the flush by 1 second: each time you press it will be validated by the motor running for a short period.

To exit programming mode:

- Wait for 5 seconds without pressing any buttons.

The motor runs for 2 seconds, this means that you have left programming mode.

Comment 1: the minimum length of the first rinsing flush for the normal flush is 19 seconds (default programming) and the maximum length is 25 seconds.

Comment 2: the normal flush cannot be modified.

58 USAGE

- 1 - The **SANICOMPACT®** pump/macerator does not require any special maintenance.
- 2 - **WARNING: The SANICOMPACT® should only be used for the evacuation of normal human waste, toilet paper and household toilet cleaners. Damage may occur to the motor if the following are disposed of via the toilet: cotton wool, tampons, sanitary napkins, wet wipes, kitchen towels, condoms, dental floss as well as other fabric or hard objects. Solvents, acids and other chemicals can also cause damage to the unit, and will invalidate the warranty.**
- 3 - **WARNING:** In case of prolonged power failure, or going on vacation, please close the stop valve of the the sink and water supply.

57 RETURN OF THE UNIT

In the unfortunate event that the **SANICOMPACT®** is defective and has to be returned for service, we suggest to remove the macerating/pump from the porcelain bowl. Please ensure that it has been thoroughly cleaned and disinfected inside and outside prior to packaging for dis-

patch. Do not submerge the motor completely in water; the electrical components might be damaged beyond repair.

53 DISMANTLING AND REMOVING THE MOTOR FROM THE TOILET

FOR QUALIFIED PERSONNEL ONLY

1. Disconnect the **SANICOMPACT®** from the electrical supply.
2. Close the Shut-Off valve and disconnect toilet supply tube.
3. (If installed) Close Gate or Ball Valve and disconnect from discharge pipe system.
4. Current model the screws holding the Sanicompact are on the sides.
5. In the rear of the unit, look for a clear plastic hose going from the solenoid valve to a black elbow in the top of the bowl. With a twisting motion pull the black elbow out of the porcelain.
6. In the rear of the unit, look for a large rubber elbow, going from the motor to the p-trap of the toilet. Unscrew the gear clamp near the motor (holding the rubber elbow).
7. The motor is assembled in the reverse of the above.

Special Note for Service People: In order to inspect the blade and motor mechanism, a Torx (#20) bit will be needed to remove the cover. There are 12 screws holding the case cover. In order to inspect the capacitors, circuit board and electronics, Triwing (#3) bit will be needed. Only four screws hold this cover.

IMPORTANT / SERVICE

Before returning the motor to the factory, a return authorization is needed from the manufacturer since some repairs may be done in the field. Parts or motors send in for repair, must be send pre-paid. Units sent collect and/or sent without prior authorization, will be refused.

Package the macerating/pump unit properly with adequate shock absorbent material around it. Send package prepaid to the manufacturer, making sure to insure against loss and/or transit damage, (the amount of \$ 250.00 will suffice).

If any repairs are done outside the warranty period, or when the user damages the macerating/pump unit, an estimate of repair cost will be communicated to the customer. All repairs (parts and labour) will be done on a pre-paid basis only.

6 ADVICE

PIPE SUPPORTS

All sanitary pipe work must be supported, in accordance with the pipe manufacturers recommendations, to avoid dipping, which may cause the build up of residual water and subsequent blockage.

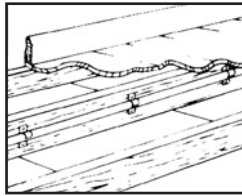

BENDS

Where possible long sweeping bends should be used. Do not use short straight elbows. If sweeping elbows are not available, use two 45 degree elbows back-to-back to make a 90 degree turn.

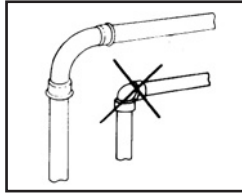

VERTICAL INSTALLATION FIRST

If vertical lift is required, this must precede the horizontal pipe run.

The vertical discharge pipe should first bypass the bowl, do not extend the horizontal portion of the pipe for more than 12-18 inches.

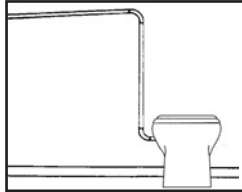

EASY ACCESS

The unit should be accessible and removable in the event of maintenance being required. During the installation a full-port gate valve should be fitted at the base of any vertical discharge pipe work from the unit to allow easy removal of the unit without flooding.

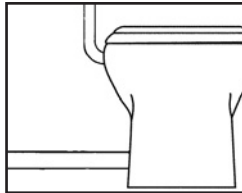

GRAVITY FALL

Horizontal discharge pipe work must also have a positive gravity fall to allow free drainage when the pump stops.

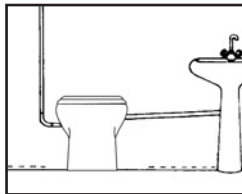

THREE FEET MINIMUM

The macerating/pump must have at least 3 feet of total pipe run in between the pump and soil stack. This will cause the macerator to operate for an adequate period of time to ensure waste reduction.

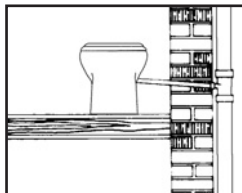

SOIL STACK CONNECTION

This unit must discharge into a minimum 3-inch sanitary drainage pipe. All discharge pipe work must be connected to the soil stack by an appropriate and approved TY connection. Please note: the use of a Saddle Clip may be prohibited in your area.

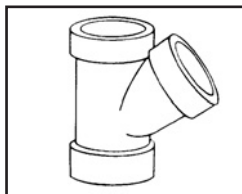

NO DIAGONAL "UPHILL" PIPE RUNS

All discharge pipe work from the unit should run either directly vertical upwards from it or in a horizontal plane (with a small gravity flow) to the point of discharge. Pipe work should not be installed with diagonal upward slope from the unit.

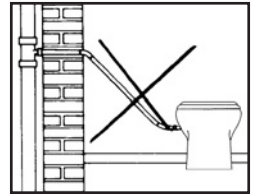

PIPE WORK

All pipe work should be either copper or solvent weld plastic (PVC, CPVC). Do not use flexible pipes.

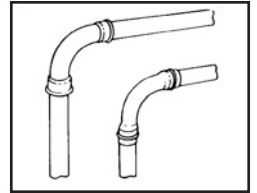

DISCHARGE

Never discharge directly into an open drain, manhole or rainwater drain pipe. It is illegal.

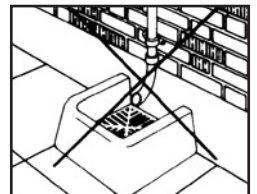

FREEZING

Ensure all pipe work susceptible freezing is adequately insulated. The toilet and macerating/pump unit must be properly winterized in unheated buildings.

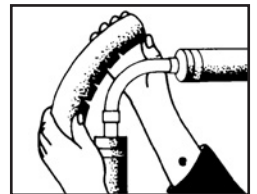

ELECTRICITY

Before attempting any maintenance or servicing, the unit must be disconnected from the power source. The **SANICOMPACT**® must be connected to a Ground Fault Circuit Interrupter and be supplied with 120V, 60Hz.

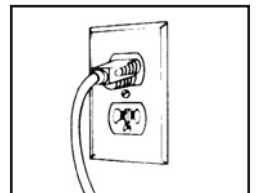

LIMITED WARRANTY

Warranty period two-year from date of purchase

Subject to the conditions listed below, SFA-SANIFLO INC. (hereinafter called the «Company») guarantees to repair or at its option replace the product or any component thereof, which, in the opinion of the Company, is faulty or below standard as a result of inferior workmanship or materials.

If replacement is to be issued, this will only be extended to the first 180 days starting from the date of purchase. Warranty repairs will apply after such date up to the warranty's date of conclusion.

Note that the replacement and repair option would only apply to the motor block inside the porcelain. If there is no damage to the bowl, Saniflo will replace the motor only without the porcelain bowl. In case there are damages to the porcelain, it would be the responsibility of the consumer to provide this information to the manufacturer within 30 days from the date of purchase.

CONDITIONS

The conditions of this guarantee are:

1. The product must not have been subjected to misuse, neglect, accident or damaging products, in accordance with these installation instructions.
2. The product must be connected to a single phase 120V, 60Hz electrical supply.
3. The alleged fault or defect must be notified to the company, within the warranty period.

PART OR PRODUCT EXCHANGE

The product will be exchanged, free of charge, at the original resellers place of business only, upon the following conditions being fulfilled:

1. The customer needs a «return authorization» number from the company to authorize and validate the exchange.
2. The customer must supply a copy of their invoice to validate the request for an exchange.

LIMITATIONS

1. Vitreous china is guaranteed only for a factory defect.
2. Cost of disconnection and reconnection (i.e. labor charges) are not covered by the warranty and are the end-users responsibility.
3. Cost of mail or freight when a part or parts of the system have to be repaired at the company are not covered by this warranty.
4. In no event shall the company be reliable for any special, incidental or consequential damage, loss, or injury of whatsoever nature or kind arising from or in connection with the product or any component thereof.
5. The guarantee is transferable only when the product remains at the same premises as where it was installed initially.

Except as set forth in this Limited Warranty, the company disclaims all other warranties, express or implied, with respect to the product or any component thereof including, but not limited to, all implied warranties for merchantability and fitness for a particular purpose

For service or for further inquiries, please call or contact one of the following addresses:

United States

SFA-SANIFLO INC.
105 Newfield Avenue, Suite A
Edison, NJ 08837

Toll Free: 1-800-571-8191
Telephone: 1-732-225-6070
Fax: 1-732-225-6072
E-mail.: sfasales@saniflo.com
Web Site: www.saniflo.com

Canada

SFA-SANIFLO INC.
1-685 Speedvale Avenue West
Guelph, ON
N1K 1E6

Toll Free: 1-800-363-5874 English
Toll Free: 1-800-877-8538 French
Telephone: 1-519-824-1134
Fax: 1-519-824-1143
E-mail.: sales@saniflo.com
Web Site: www.saniflo.ca